



XCELLERATOR 1/2" INCH SPRING PIN REPLACEMENT INSTRUCTIONS



Please read the entire instruction manual before proceeding with Wedge Spring Pin Assembly replacements.

Included Components:

- 2x Spring Pin Assemblies for each Xcellerator Starting Block
- 2x 1/2" Jam Nylock Nuts
- 4x 1/2" Flat Washers

Tools Needed:

- 7/16" Wrench (Rear Rail Weldment Acorn Nut)
- 5/8" Wrench (Interior Spring Pin Assembly)
- 3/4" Wrench (Exterior Spring Pin Assembly Nut)
- 5/32" Allen Wrench (Rear Cover Screws and Rear Rail Weldment Screws)



1. Remove the rear screws and acorn nuts from the left and right rail weldments using a 5/32" allen wrench and 7/16" wrench simultaneously. This will ensure that the wedge can be removed from the starting block.

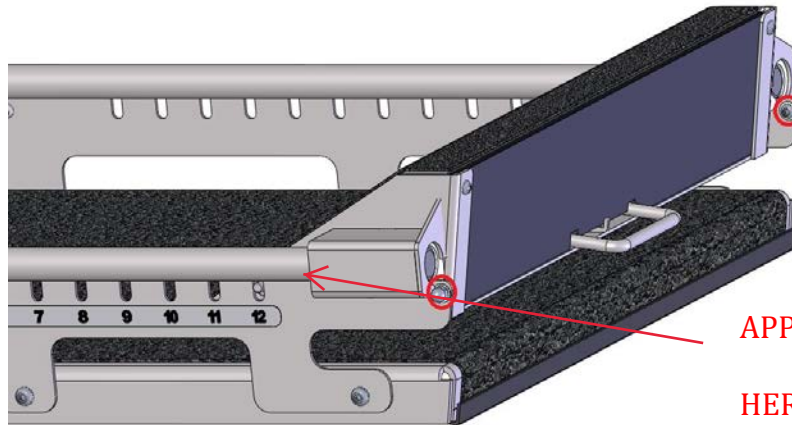

APPLY LUBRICANT
HERE ONCE A
MONTH

2. Remove the wedge from the starting platform.
3. Remove the plastic backing from the rear of the wedge by removing the two screws using a 5/32" allen wrench.

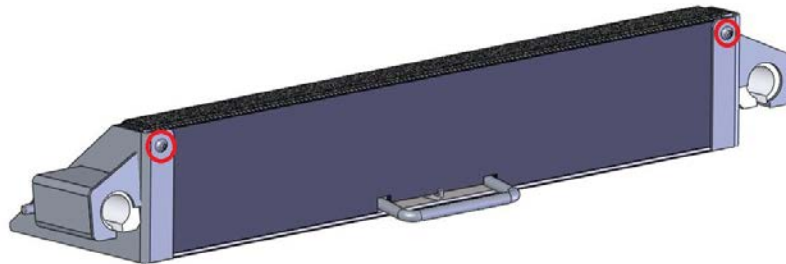

4. Remove exterior nuts on the left/right sides of the wedge using a 3/4" wrench on the exterior nut and 5/8" wrench on the interior nut simultaneously.

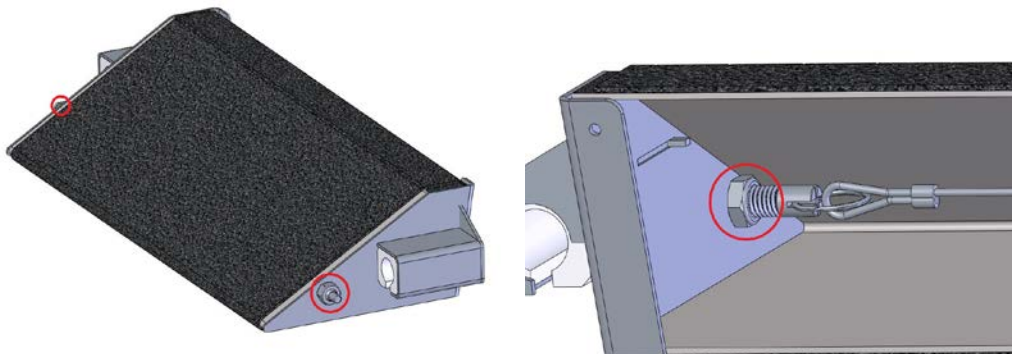



5. Remove each old spring pin assembly and then disconnect the two split rings from the wedge cable. Remove the old spring pin assemblies from the wedge.
6. Connect the new left and right spring pin assemblies to the wedge cable using the split key rings.
7. Locate the spring pins in the left and right exit holes of the wedge, leaving threading for the exterior nuts. NOTE: placing washers on the interior of the track start wedge will help to fine tune how far the spring pin protrudes from the wedge when engaged. Ensure that the pin does not touch the grab rail weldments when retracted.

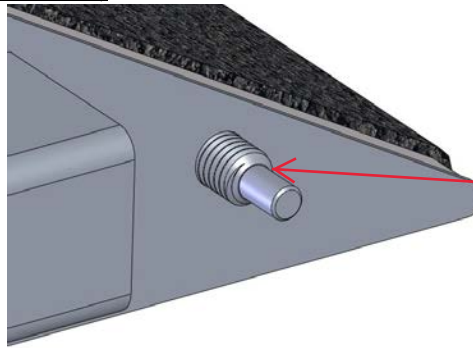

**APPLY LUBRICANT
HERE ONCE A
MONTH**

8. Tighten exterior nuts down with a $\frac{3}{4}$ " wrench and interior nuts with a $\frac{5}{8}$ " wrench until the spring pin assembly is secure. Complete this step for both the left/right side of the wedge.
9. Test the spring pins by pulling on the handle connected to the wedge cable.
10. Replace the plastic backing on the rear of the wedge. Then re-apply the rear screws to the wedge using a $\frac{5}{32}$ " allen wrench.
11. Place the wedge back on the starting platform, making sure that the spring pins slide freely during adjustment and engage with the grab rail weldments when handle is released.
12. Replace the rear screw and acorn nuts on the left and right rail weldments to secure the wedge to the starting platform.
13. Repeat this process for all required Xcellerator Starting Blocks.



XCELLERATOR TRACK START WEDGE REGULAR MAINTENANCE GUIDE

1. Inspect current spring pins on track start wedge for corrosion, damage, and proper engagement with the side rails when extended. Ensure that the spring pins do not make contact with the side rail weldments during wedge adjustment; and that the spring pins locate properly when adjustment handle is released.
2. If pins require replacement, ensure the correct replacement parts are used. This can be checked by measuring the threaded portion of the spring pin body (either 1/2" or 3/8" diameter). Consult the Spring Pin Replacement Instructions for further detail on replacement.
3. Inspect and test the spring pins monthly. Apply food grade silicone to the pin and rotate/pull on the pin several times to allow the lubricant to work its way into the body of the part to maintain proper action of pins.
4. Apply WD-40 to the side rails with the exception of the front 6 inches that the swimmer utilizes during a start. This ensures smooth motion of the track start wedge along the rails during adjustment.
5. *****Encourage swimmers to use the track start wedge properly*****
Ensure that the pins are extended and located in a slot before initiating a start. Performing a start without proper pin location will result in damage or failure of the pins.

