

Grab Rails, Kokanee 60", product number 35007

Rails

The grab rails shall be fabricated of 1.50" O.D. x .083", or .120" wall thickness 316L stainless steel. It shall have four bends that are to be wrinkle free. The grab rails shall be designed for a setback of 60" from pool edge. Sold as an individual rail.

Anchors and Escutcheons

The grab rails shall be supported by two (2) 4" bronze wedge anchors and two (2) stainless steel keyhole escutcheons.
(Not Included)

Warranty

Two year limited warranty.

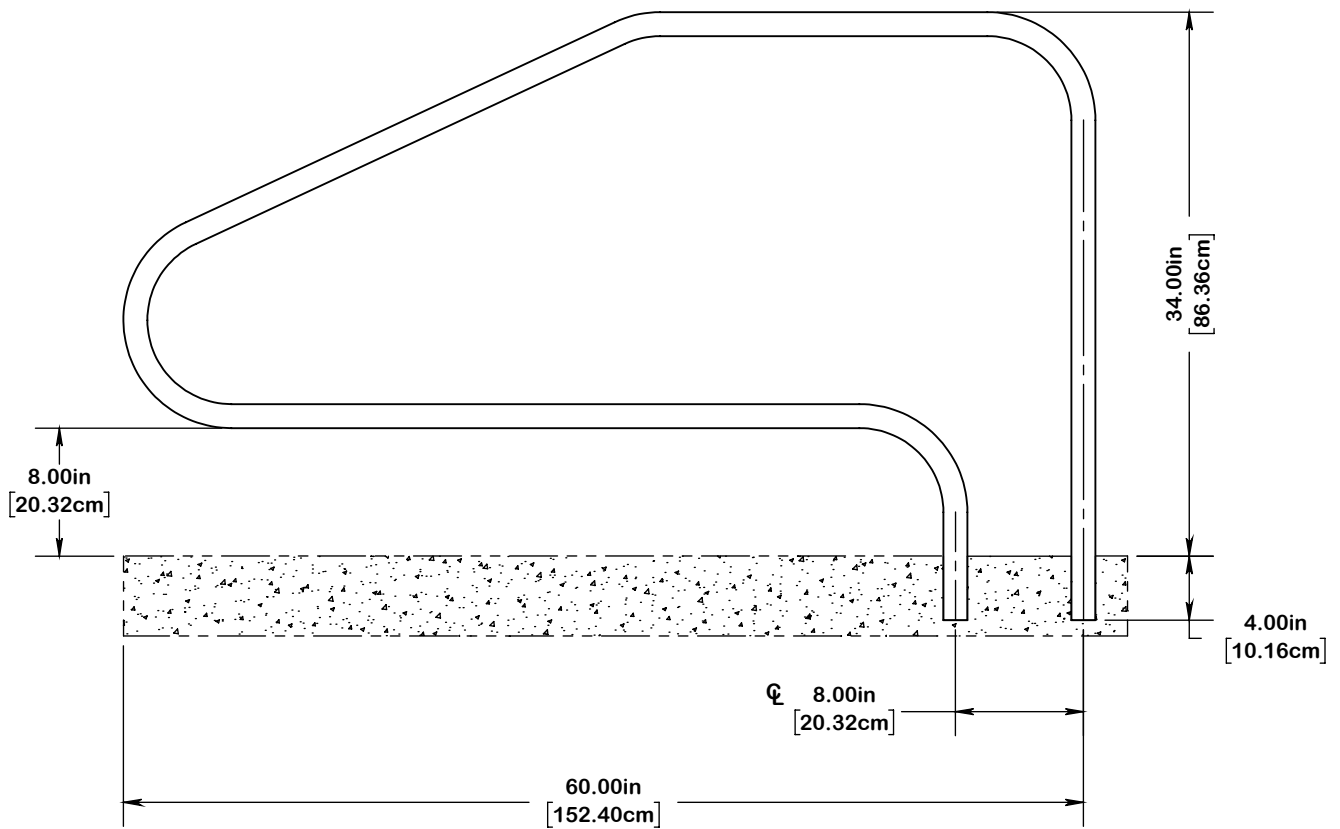
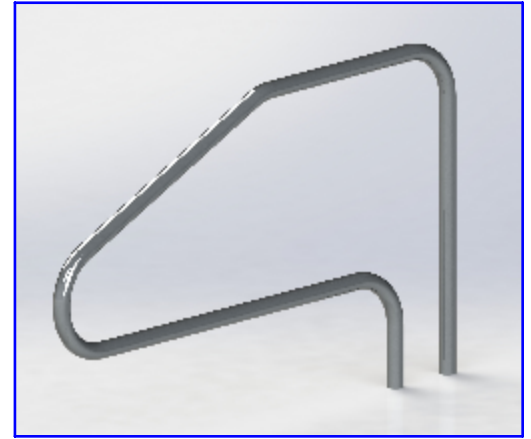

NOTE:

△ DIMENSIONS VARY WITH SPECIFIC APPLICATIONS. SPECIFICATIONS ARE NOMINAL AND ARE SUBJECT TO CHANGE. PLEASE CONTACT SPECTRUM AQUATICS FOR CUSTOM APPLICATIONS



A PLAYCORE Company

7100 Spectrum Lane
Missoula, Montana 59808
800.791.8056
www.spectrumaquatics.com

ENGINEERING DATA

PRODUCT:	60" KOKANEE - 1.50 -		
MODEL #:	KOKANEE	CATALOG #:	35007
REVISION:	A		
MATERIAL:	STAINLESS STEEL		
FINISH #:	BUFFED TO NEAR #6 FINISH OR 500 GRIT		